

MONTANA

THE WORLD OF EXCELLENCE

ski & board service machines | rental systems | skins



PRESS RELEASE

ISPO BOOTH **B5.450 / B5.540**

DEPOT SYSTEMS

WITH VERSATILITY IN ALL DIMENSIONS



The depot systems are designed for convenient storage and drying of ski equipment and meet every requirement profile.

Be inspired by the numerous material combinations and individual design possibilities.

FUSIONTEC SKINS ADHESION BY MONTANA

THE NEW DEFINITION OF HOLD

THE NEW MONTAMIX ADRENALINE



with the new FUSIONTEC adhesive for a revolutionary hold of the climbing skins

MONTANA⁺
skins

climb | glide
●●●●● | ●●●○



feel the adrenaline

FUSIONTEC is the groundbreaking skin coating from MONTANA, which will be presented for the first time at ISPO 2020 in Munich. This innovative and ingenious product sets new standards in terms of adhesive properties and handling. At the market launch, the new FUSIONTEC adhesive with the specially designed ADRENALINE skin design will be available in proven MONTAMIX quality and offer a very special snow sporting experience for ski tourers of all kinds..

- Revolutionary glueless adhesive
- Quick and easy application of the climbing skin
- Sticks as securely as necessary but little as needed
- Cold weather resistant and residue free
- Washable without loss of adhesiveness
- No protective covering needed during transport or storage
- Easy and uncomplicated handling



GRIPtech SYSTEM – THE REVOLUTION IN PREPARING THE SIDE EDGE



The best from belt and disc grinding. The unique process grinds all functional areas of the ski from shovel to tail to RACE EDGE quality. This results in the maximum durability of the sharpness combined with a removal which is gentle on the material.

The unique vertical grinding process provides a particularly beneficial sharpness and edge shape (microstructure). For full skiing pleasure.

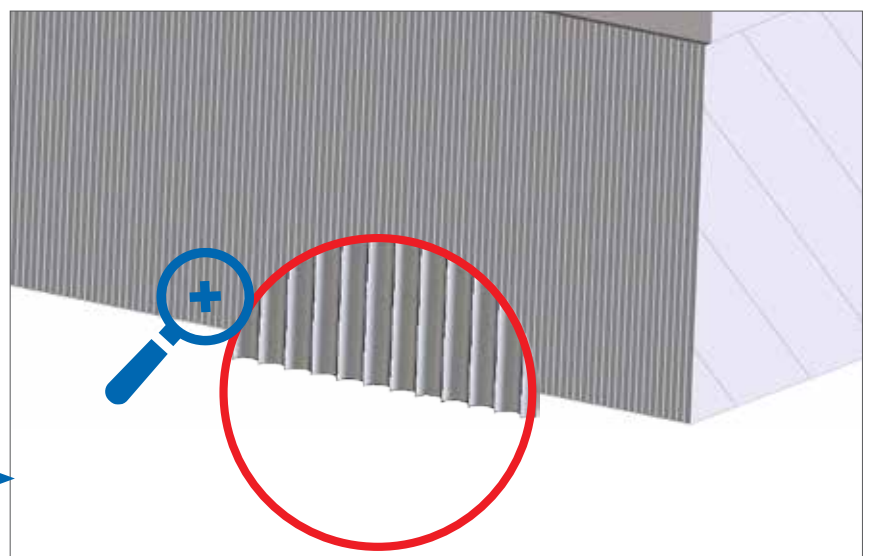
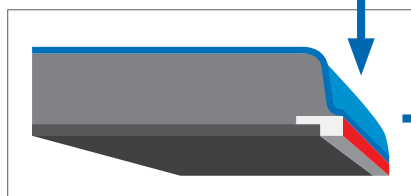

THE NEW ROBOTS

WORLD DEBUT OF CRYSTAL MAGIC, CRYSTAL ONYX AND CRYSTAL ROCK

The brilliant machine concept allows for a truly individual configuration as a function of throughput and service steps. The new robots are a revolution in ski service regarding performance and result.

CRYSTAL ROCK

CRYSTAL ROCK ALL-ROUND ROBOT FOR SMALL AND MEDIUM-SIZED SHOPS



The wide grinding stone makes the CRYSTAL ROCK the optimal system for small and medium-sized shops. Also ideal as it can be used for both skis and snowboards.

The new GRIPtech system for the side edge provides a leap in quality in ski and snowboard service: creating a precise, sharp, and durable RACE EDGE quality edge. Together with radial tuning it delivers an edge with unique properties.

CRYSTAL MAGIC

INGENIOUS ROBOT SYSTEM FOR PREMIUM SKIS AND SNOWBOARDS

The brilliant machine concept allows for a truly individual configuration as a function of throughput and service steps – find your choice among 5 sizes and 92 possible versions.

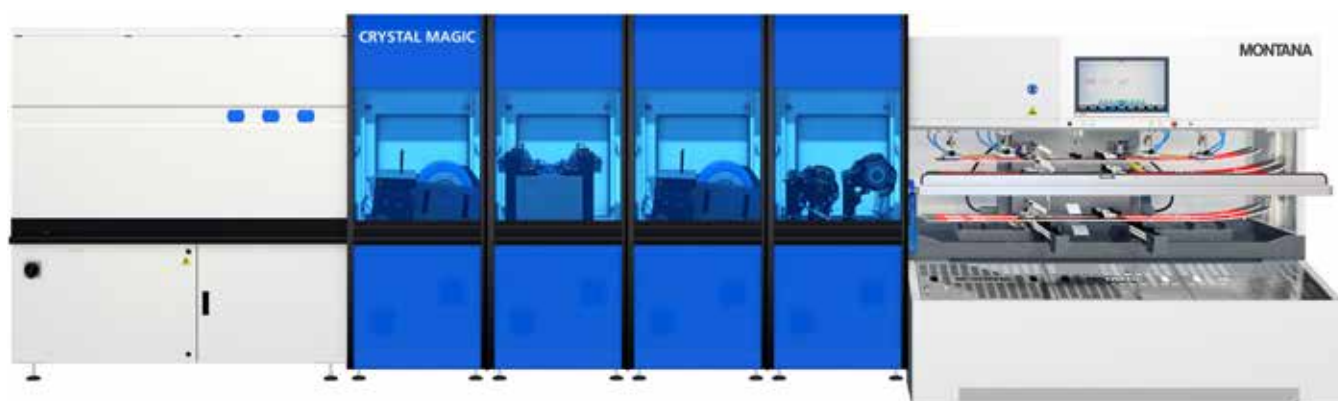

The new CRYSTAL MAGIC robot with a high hourly output was developed specifically for shops with medium to high ski service volumes. The robot features an impressive technology of the highest level with unbeatable modularity: 19 base versions for an optimal configuration to meet the needs of the shop. The wide stone makes the CRYSTAL MAGIC the optimal solution for working on skis and snowboards by robot. Available with 1 or 2 stones.

The system comes standard with PRO-technology. It delivers particularly gentle grinding for all ski and snowboard models, particularly rockers –

including grinding the shovel and tail.

The new GRIPtech system for the side edge provides a leap in quality in ski and snowboard service: creating a precise, sharp, and durable RACE EDGE quality edge. Together with radial tuning it delivers an edge with unique properties. To improve glide, choose between traditional wax and polish aggregate and the WinTheRace covering process. This turns CRYSTAL MAGIC into a full service robot.

MONTANA DIGITAL WORLD

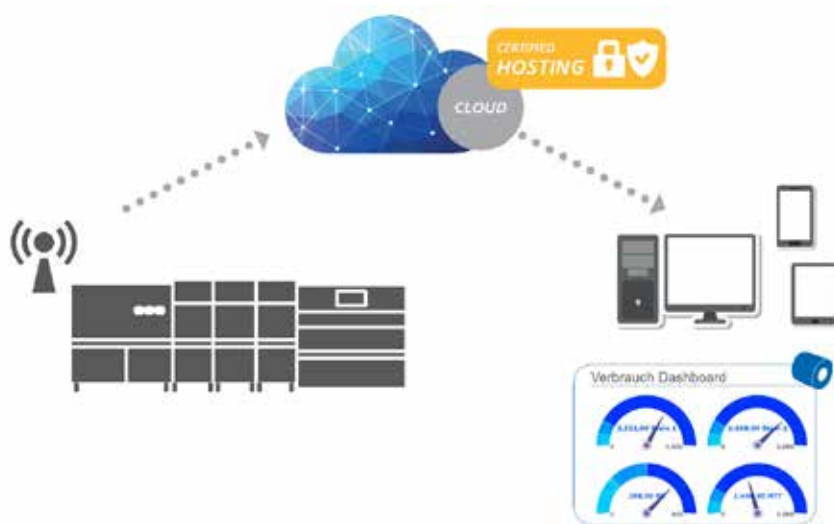

Montana Digital World is the new Cloud Service from Montana, facilitating the speedy integration of current grinding robots.

Using this service, our customers can access all the important information regarding the system status, operations and usage, anytime and anywhere.

Statistics on capacity and cycle times promote optimal operations.

In the digital machine cockpit, the user receives a quick overview of the degree of wear suffered by the expendable materials, either on their PC, tablet or smart phone.

This information allows for a good level of calculability with regards to the replacement of expendable materials.

Security is certain, as flexible user management ensures secure access to machine data as well as customised displays; Montana Digital World supports all current security standards in order to effectively protect our customers' data.

EXAMPLES OF RETRIEVABLE INFORMATION:

- status, workload, throughput
- Consumables – status, remaining time, usage statistics
- Quantities per day, recipes, customers

MONTANA DIGITAL WORLD IS ACCESSIBLE:

- From any location worldwide via the internet
- Using any common end device via the web browser
- Securely via a server localised in Germany (German Data Protection Directive)
- With user-defined access authorisation
- For encrypted and certified data transfer

The MONTANA Cockpit establishes the transparency that is necessary for our customers to achieve the best possible efficiency. With MONTANA DIGITAL WORLD, real-time processes can be viewed anywhere at any time. Preventative maintenance and automated services produce the best work results every day.

MONTANA WINTHERACE – THE INTELLIGENT ALTERNATIVE TO WAXING!



The FIS has issued a complete ban on fluorine waxes, and the announcement of an EU regulation to ban certain fluorine compounds is imminent!

Covering – not waxing: WinTheRace is a base-fluid for the preparation of surfaces of winter sport equipment. The unique coverspray consists of high molecular and super hydrophobic silicon combinations. It is applied within seconds and is absolutely non toxic. WinTheRace is odorless and ensures a fast ski in all weather conditions.

It's fully automatic application is now also integrated in MONTANA service robots.

Advantages

- Odourless, colourless, clear
- No fluorine additive
- Multifunctional from +8°C to -30°C
- Super hydrophobic – extremely water repellent
- Impregnates ski – protects against rust and corrosion
- For all snow conditions
- Easy and fast application